

Step 1

Remove the lights from track.
The new brackets will be placed where the light used to be. Make sure the bracket holes line up with the light holes on the cab. If so drill those holes out with a 1/4 inch drill bit & place the weld nuts in the 1/4 holes.



Step 2

Run the light wire through the center hole on the bracket & tighten the brackets to the cab.



Step 3

Place the visor over brackets & tighten all the screws. Remember to use original screws for the sides. If the track did not come with original visor. Then mark the hole for the sides & drill with 1/4 drill bit & place a weld nut in the hole.



Step 4

You are finished! Remove plastic from visor & clean with window.

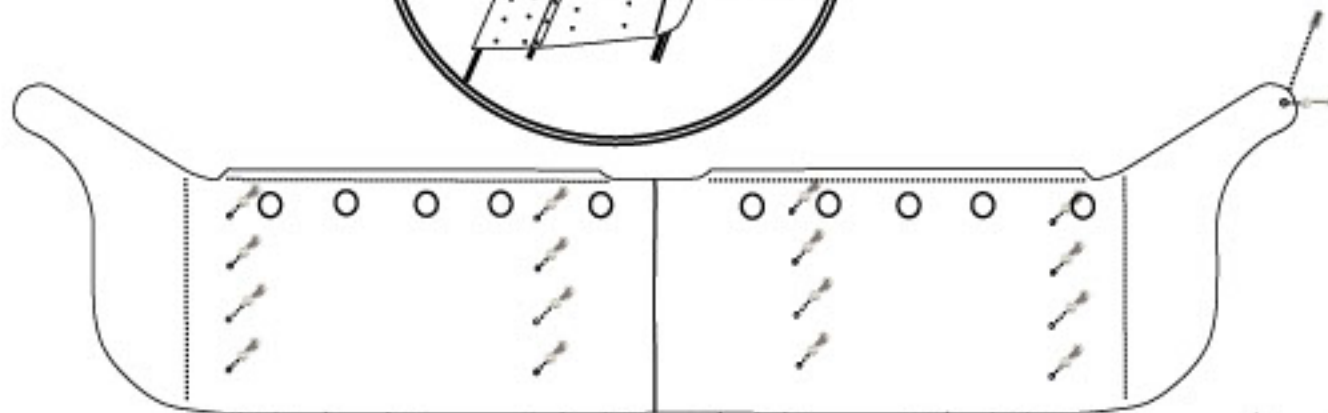
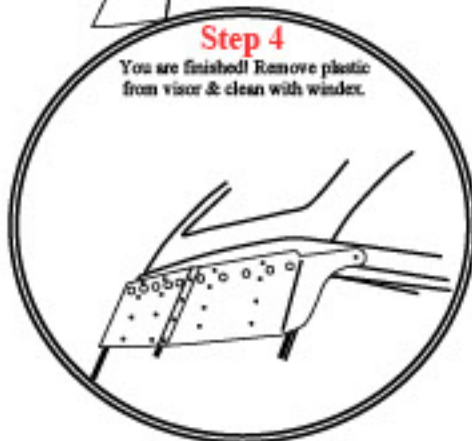

Notes

- Use silicone or something similar to patch any exposed holes once installation is completed.
- Drill carefully to avoid puncturing the cab interior.
- Insert screws "loosely" starting from outer edge to center. Then start "tightening" from center to outer edge.

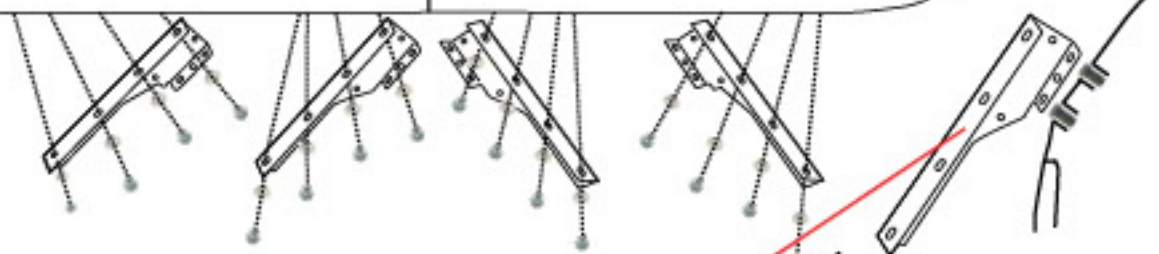

Bolt Kit

	QTY: 16	Part: Phillips	1/4 - 20 x 3/4
	QTY: 40	Part: Flat Washer	1/4 x 5/8
	QTY: 16	Part: Weld Nut	1/4 - 20 x 1"
	QTY: 16	Part: Hex Head	1/4 - 20 x 1 1/4
	QTY: 16	Part: Nylon Hex Nut	1/4 x 20
	QTY: 4	Part: Phillips	10 - 32 x 1/2
	QTY: 8	Part: Flat Washer	# 10
	QTY: 4	Part: Nylon Hex Nut	10 - 32

